

Cherokee Turnpike

Average Daily Traffic

For the year ending December 31, 2014

Length of Turnpike: 32.8 miles

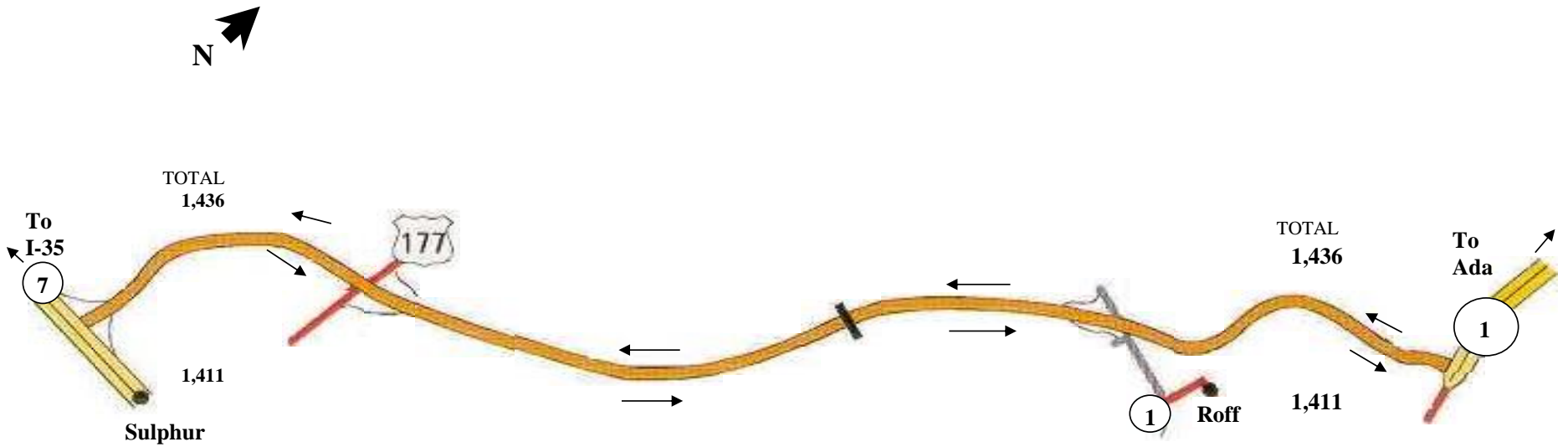

Chickasaw Turnpike
Average Daily Traffic
For the year ending December 31, 2014

Length of Turnpike: 17.3 miles

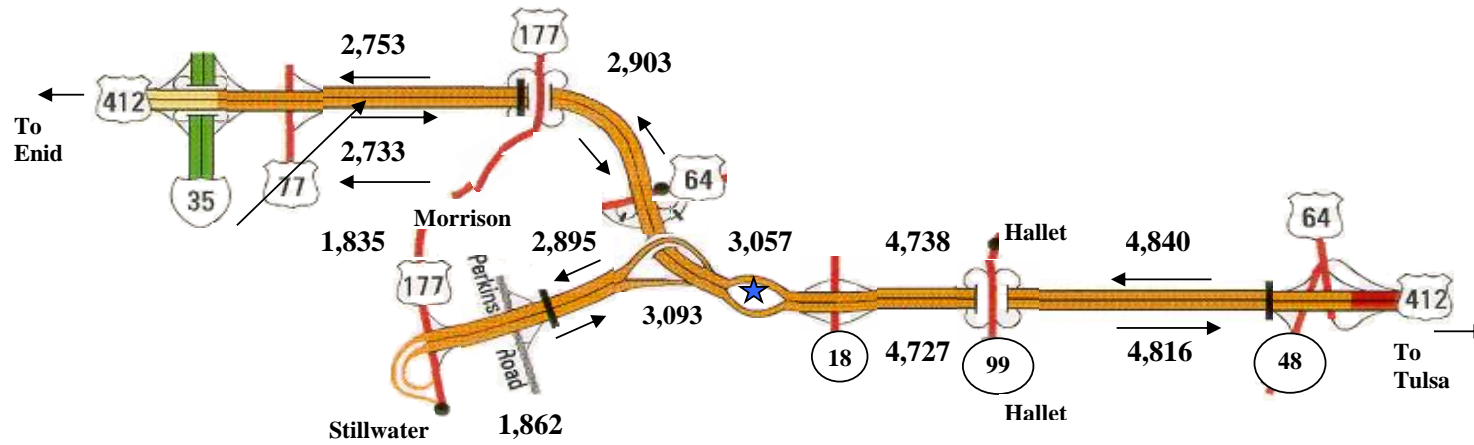

Cimarron Turnpike

Average Daily Traffic
For the Year ending December 31, 2014

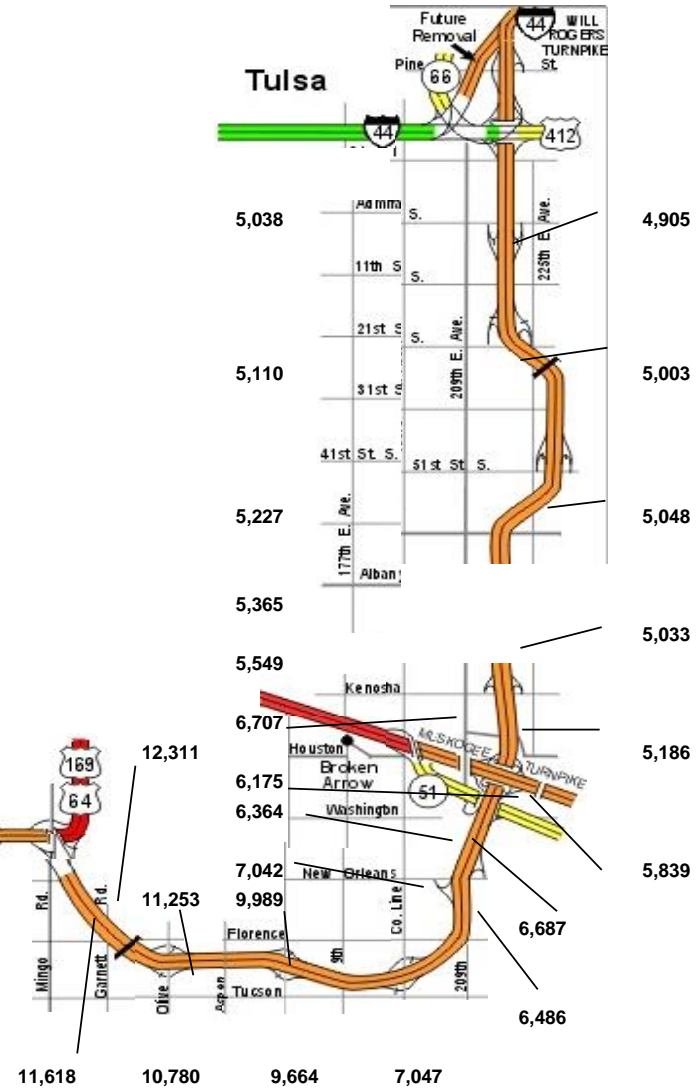
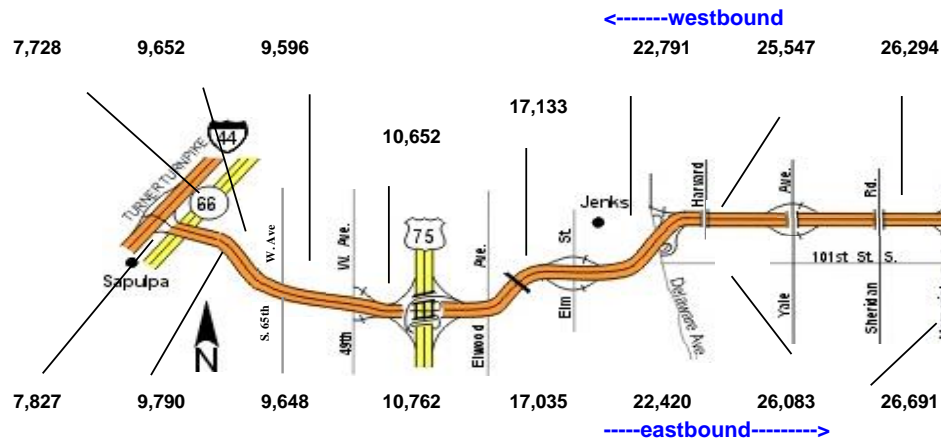

Creek Turnpike
For the year ending December 31, 2014

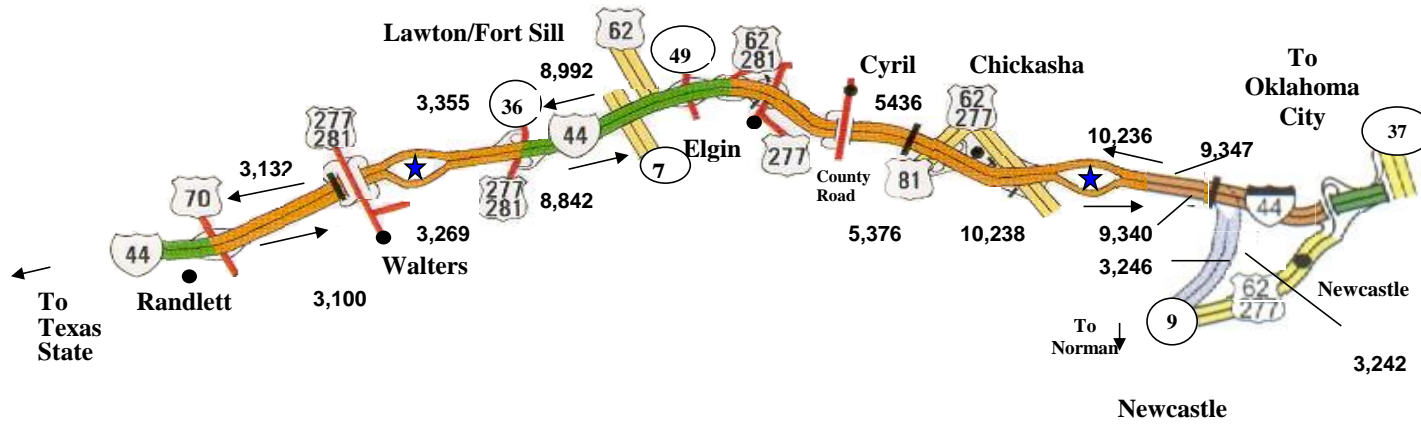

H.E. Bailey & H.E. Bailey Spur

Average Daily Traffic

For the quarter ending December 31, 2014

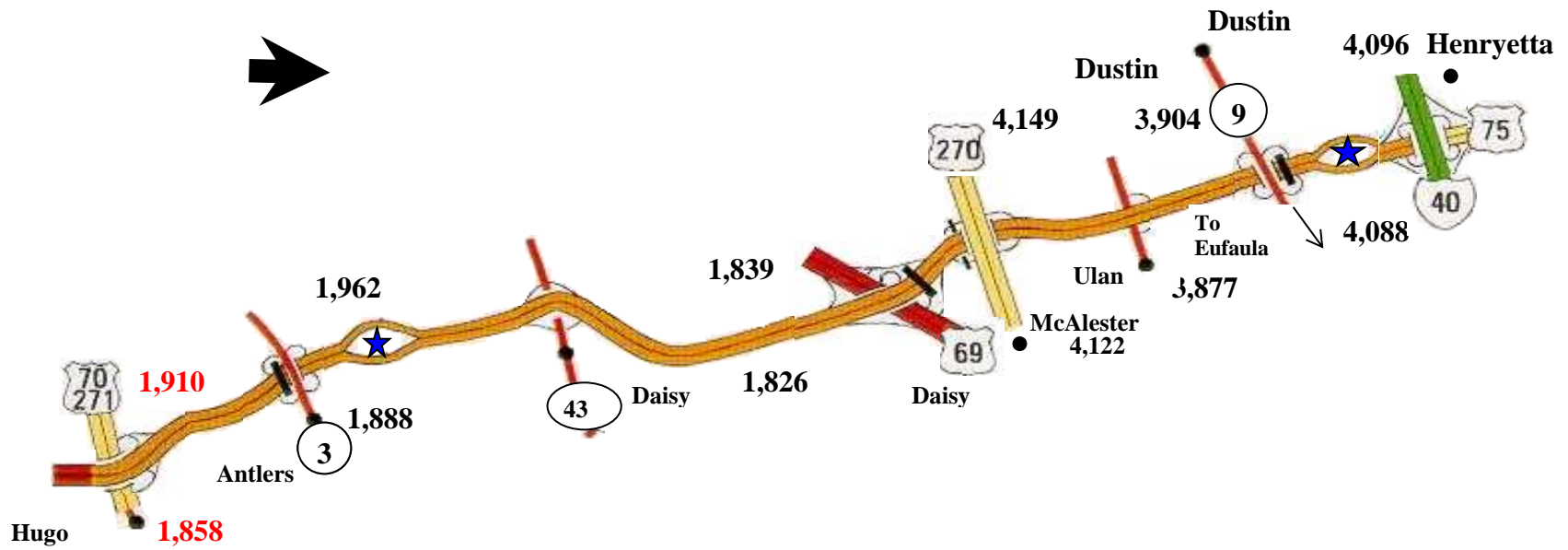

Indian Nation Turnpike

Average Daily Traffic

For the Year ending December 31, 2014

Length of turnpike: 105.2 miles

█ Eastsbound
█ Westbound

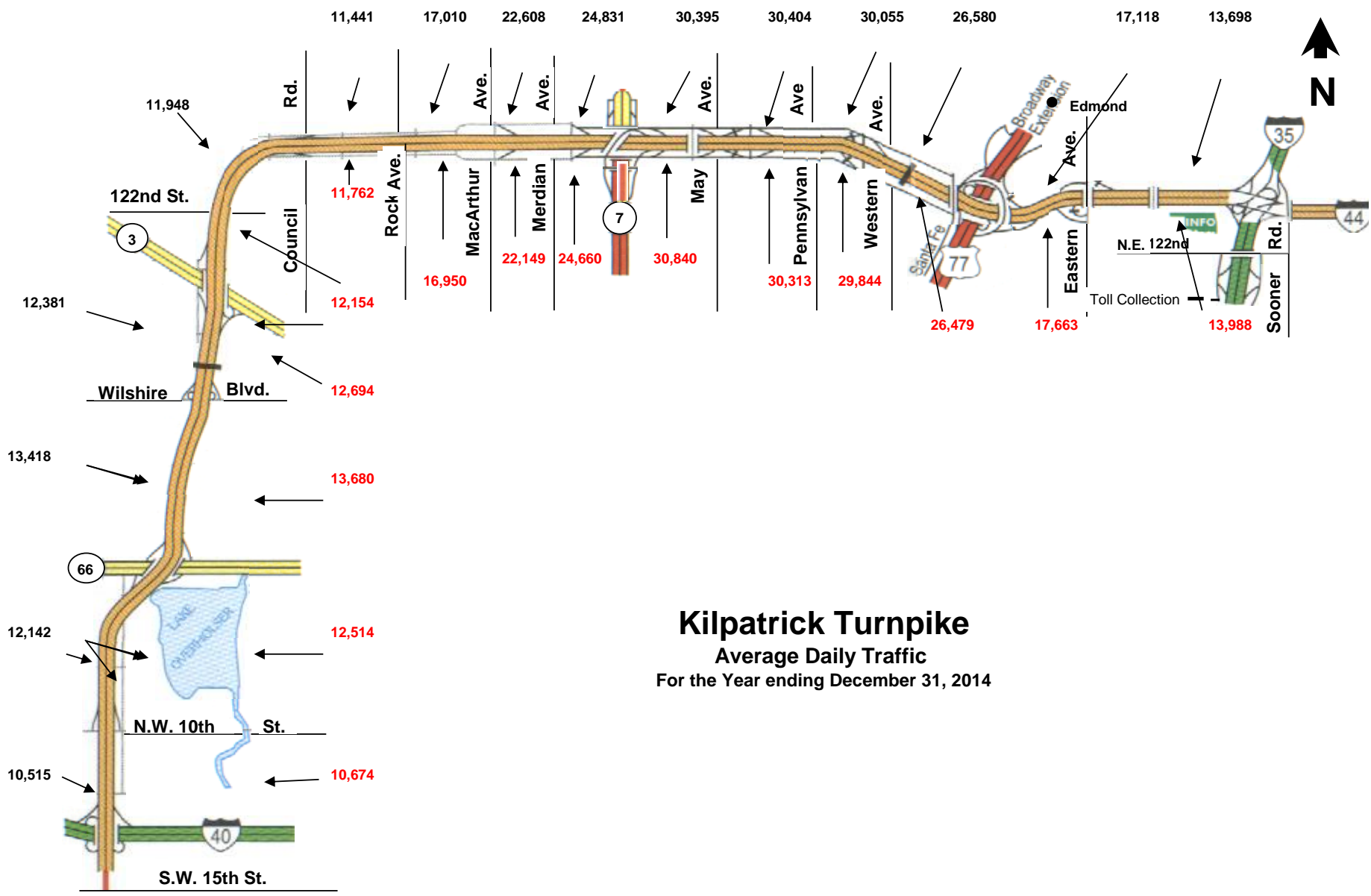

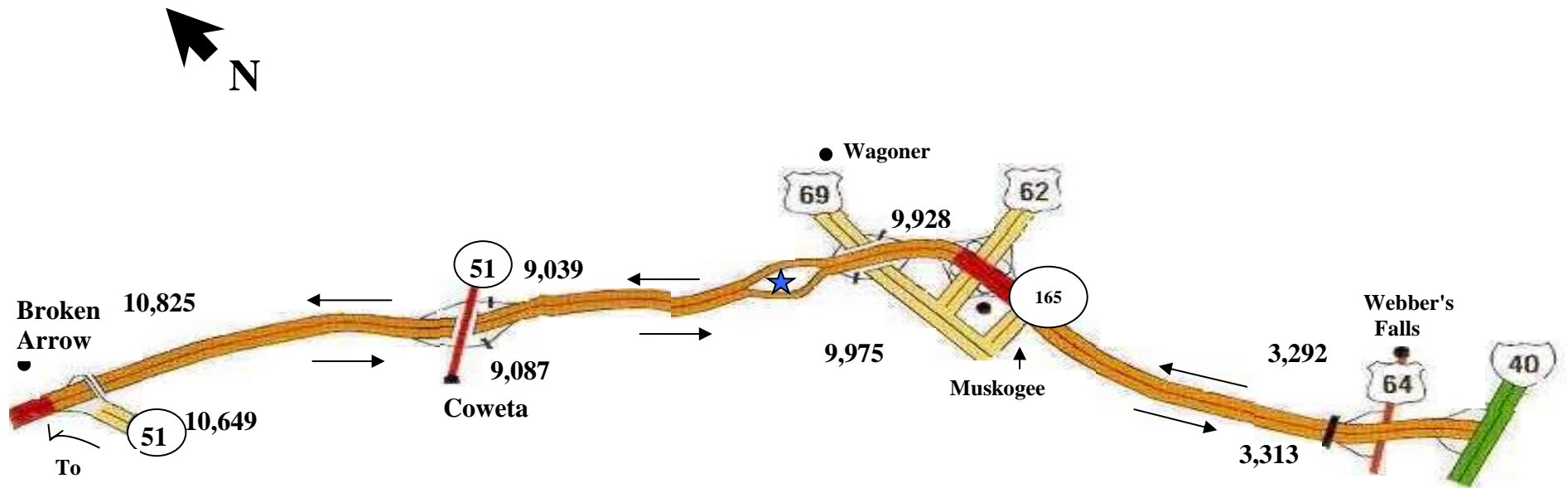

Muskogee Turnpike

Average Daily Traffic

For the Year Ending December 31, 2014

Length of turnpike: 53.1 miles

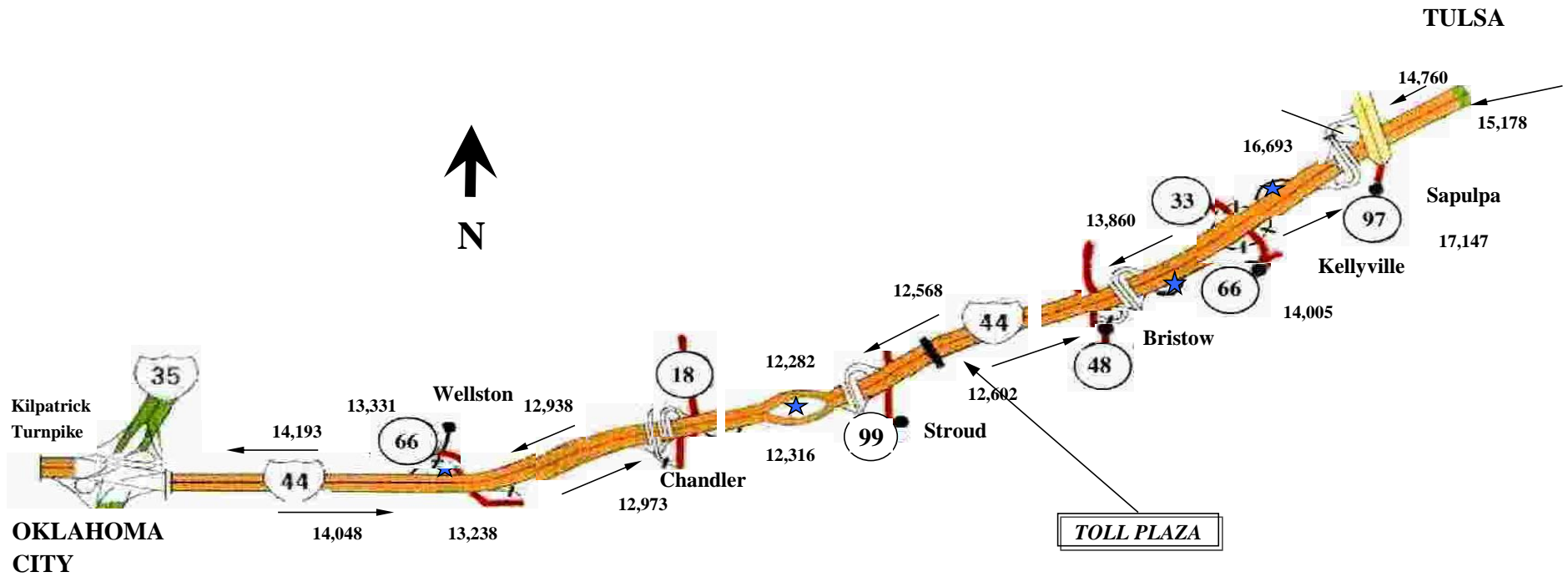

TURNER TURNPIKE
 Average Daily Traffic
 For the Year ending December 31, 2014

★ Concession Area
 Length of Turnpike: 86.0 miles

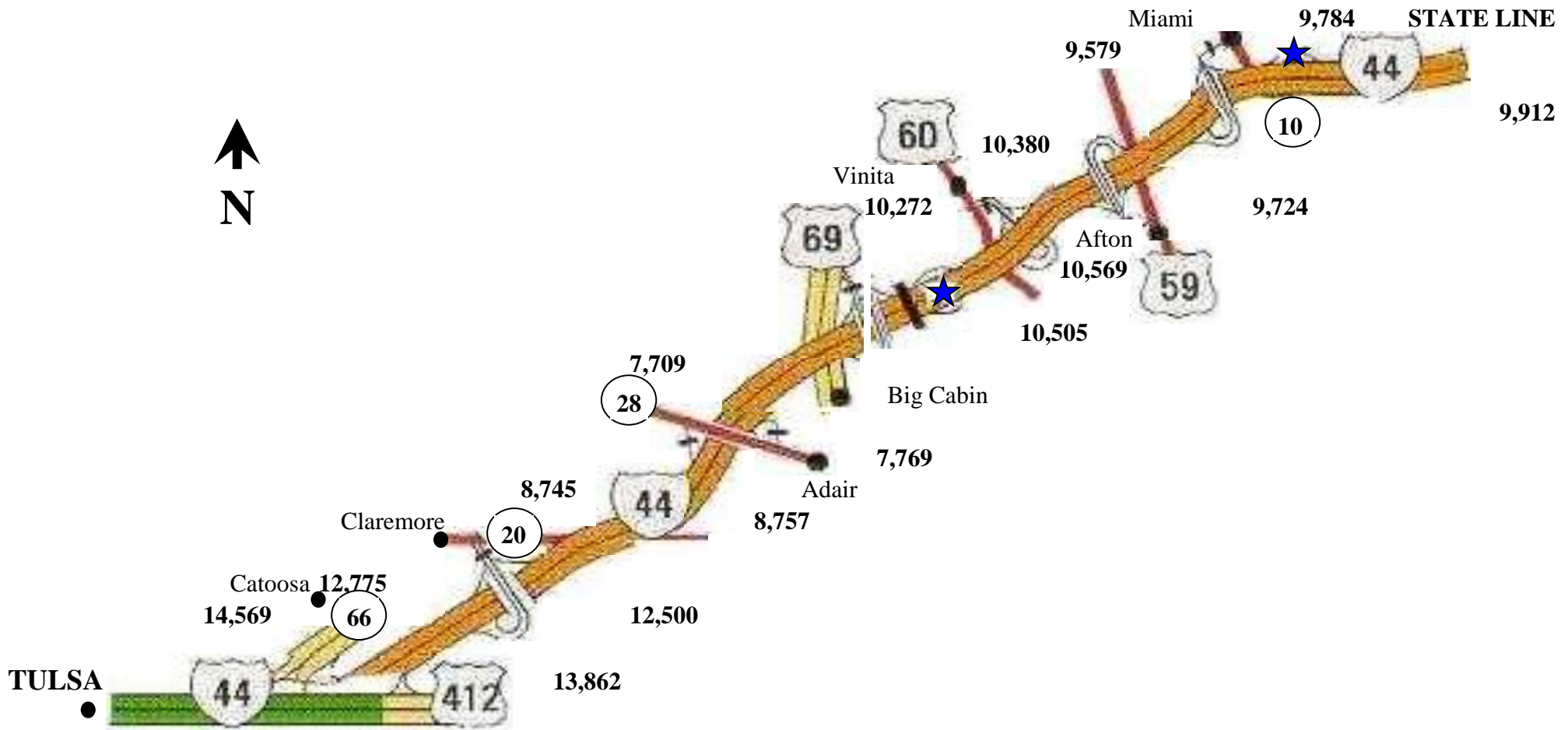

WILL ROGERS TURNPIKE

Average Daily Traffic

For the Year period January 1 thru December 31, 2014